



Straight aluminium columns

ø114 mm at the base

Anodising: 10 colours

Finish: brushed anodised aluminium, option of elastomer protection in column's colour up to a height of 350 mm (other height on customer's request)

Diameter of the column ending: ø60 mm

Protection class: IP 54 for the wiring chamber

Luminaire mounting: directly on the column or via an extension arm, luminaires with ø60 mm mounting with weight and surface parameters not exceeding the data from the strength table included in the technical data sheet



Column type	SAL-3/B60	SAL-3,5/B60	SAL-4/B60	SAL-4,5/B60	SAL-5/B60
Height of the column H [mm]	3 000	3 500	4 000	4 500	5 000
Code	42120/C...	42101/C...	42102/C...	42103/C...	42127/C...
Net weight [kg]	8,7	10	11,3	12,7	14,2
Approximate unit volume [m ³]*	0,067	0,078	0,09	0,1	0,11
Recommended luminaires for column top mounting	ISKRA LED ALFA, ISKRA LED ALFA PROG, RING 1 LED, RING 2 LED, CUDDLE MINI LED REG, ELBA LED, AURIS LED, ATLANTIS LED, MIRA LED, ELBA, OPA-1, OP, OZ				
Recommended extension arms and luminaires	WA-14/1, WA-41 fi42 - OW LED				
Concrete footing / reinforcement basket type	B-50 / Z-50				
Threaded anchor ending	4xM14				
Concrete footing / reinforcement basket code	311150 / 311205				
Fasteners	4006				
Dimension of the base plate (side / bolt spacing / thickness) [mm]	224 / 180 / 8				

* For orders of more than 10 pcs. the given volumes may change due to the method of packaging.
/C... - choice of anodising colour

Cracow, Poland



Luminaire: ISKRA LED ALFA
Column: SAL-4/B60



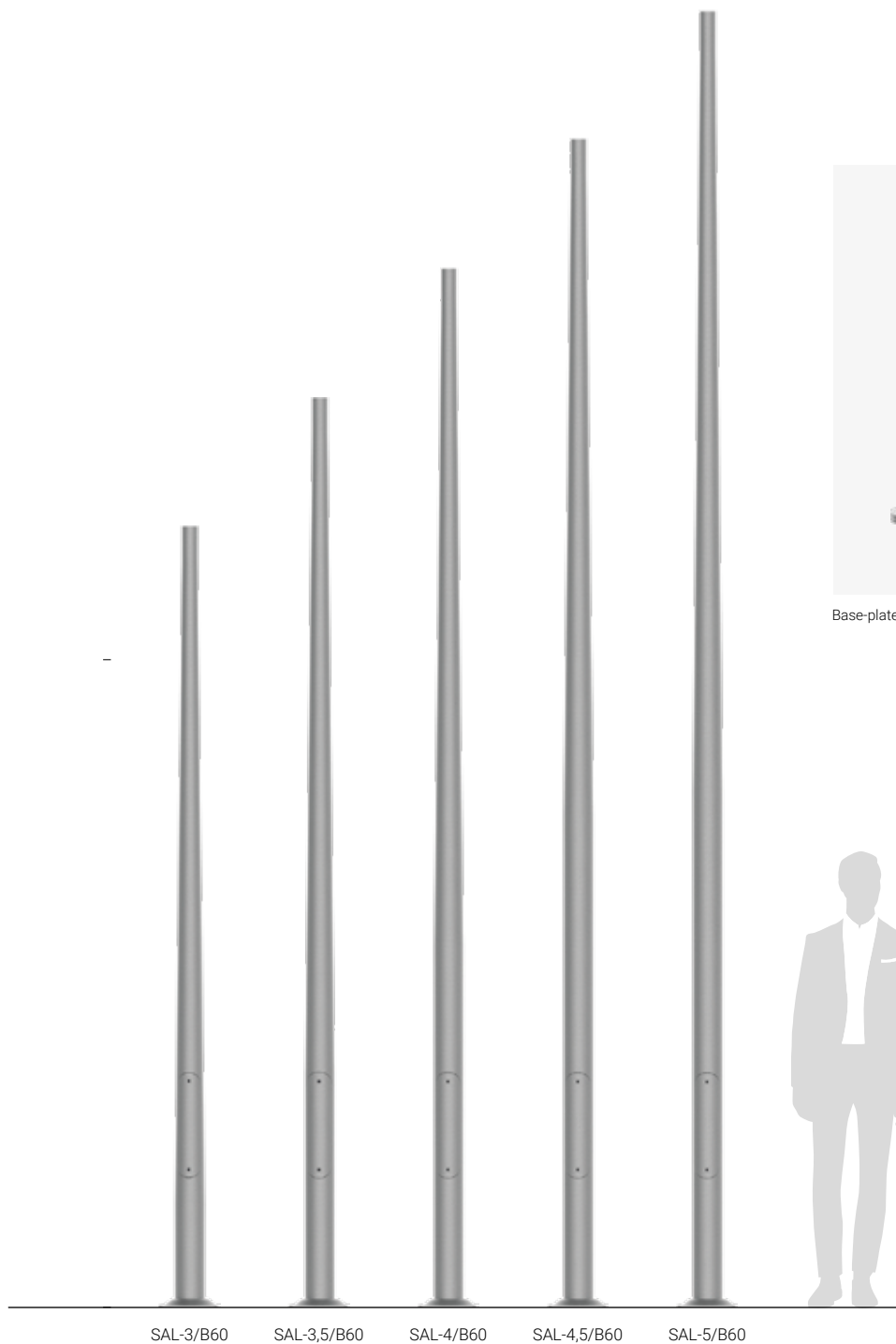

Base-plate of aluminium column 224x180x8

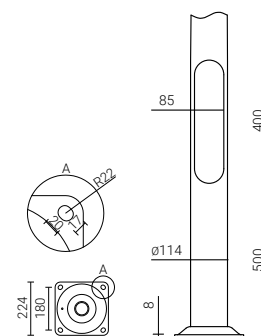

Straight aluminium columns

ø114 mm at the base

Anodising: 10 colours

Finish: brushed anodised aluminium, option of elastomer protection in column's colour up to a height of 350 mm (other height on customer's request)

Diameter of the column ending: ø60 mm

Protection class: IP 54 for the wiring chamber

Luminaire mounting: directly on the column or via an extension arm, luminaires with ø60 mm mounting with weight and surface parameters not exceeding the data from the strength table included in the technical data sheet



Column type	SAL-3/D60	SAL-3,5/D60	SAL-4/D60	SAL-4,5/D60	SAL-5/D60
Height of the column H [mm]	3 000	3 500	4 000	4 500	5 000
Code	42122/C...	42114/C...	42115/C...	42116/C...	42128/C...
Net weight [kg]	9,1	10,4	11,7	13,1	14,6
Approximate unit volume [m ³]*	0,087	0,101	0,115	0,13	0,145
Recommended luminaires for column top mounting	ISKRA LED ALFA, ISKRA LED ALFA PROG, RING 1 LED, RING 2 LED, CUDDLE MINI LED REG, ELBA LED, AURIS LED, ATLANTIS LED, MIRA LED, ELBA, OPA-1, OP, OZ				
Recommended extension arms and luminaires	WA-14/1, WA-41 fi42 - OW LED				
Concrete footing / reinforcement basket type	B-51 / Z-51				
Threaded anchor ending	4xM18				
Concrete footing / reinforcement basket code	311151 / 311251				
Fasteners	4008				
Dimension of the base plate (side / bolt spacing / thickness) [mm]	260 / 200 / 8				

* For orders of more than 10 pcs. the given volumes may change due to the method of packaging.
/C... - choice of anodising colour

Tymbark, Poland



Luminaire: ATLANTIS LED
Column: SAL-4/D60



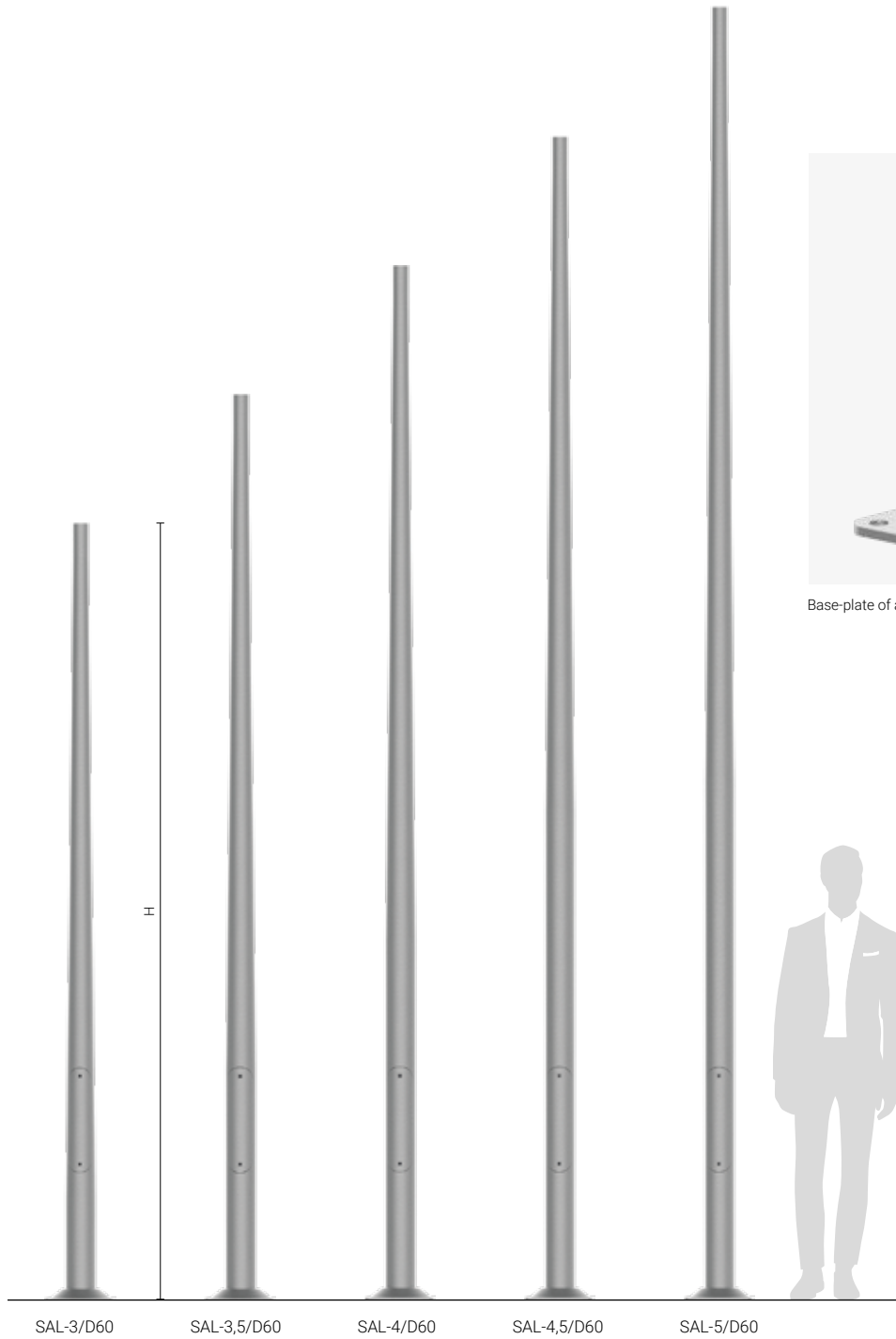

Base-plate of aluminium column 260x200x8

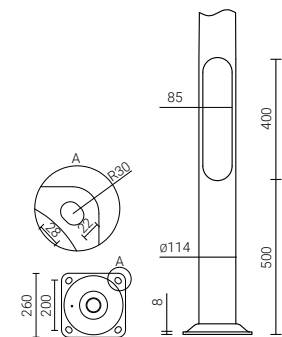

Straight aluminium columns

ø114 mm at ground level

Anodising: 10 colours

Finish: brushed anodised aluminium, option of elastomer protection in column's colour up to a height of 350 mm (other height on customer's request)

Diameter of the column ending: ø60 mm

Protection class: IP 54 for the wiring chamber

Luminaire mounting: directly on the column or via an extension arm, luminaires with ø60 mm mounting with weight and surface parameters not exceeding the data from the strength table included in the technical data sheet



Column type	SAL-3/B60 dz	SAL-4/B60 dz	SAL-4,5/B60 dz	SAL-5/B60 dz
Height of the column at ground level H [mm]	3 000	4 000	4 500	5 000
Code	42124/C...	42111/C...	42107/C...	42113/C...
Net weight [kg]	10,6	13,2	14,5	16
Approximate unit volume [m ³]*	0,024	0,03	0,033	0,036
Recommended luminaires for column top mounting	ISKRA LED ALFA, ISKRA LED ALFA PROG, RING 1 LED, RING 2 LED, CUDDLE MINI LED REG, ELBA LED, AURIS LED, ATLANTIS LED, MIRA LED, ELBA, OPA-1, OP, OZ			
Recommended extension arms and luminaires	WA-14/1, WA-41 fi42 - OW LED			
Rooted section h [mm]	800			

* For orders of more than 10 pcs. the given volumes may change due to the method of packaging.
/C... - choice of anodising colour

Duszniki-Zdrój, Poland



Luminaire: ELBA LED
Column: SAL-4/B60 dz

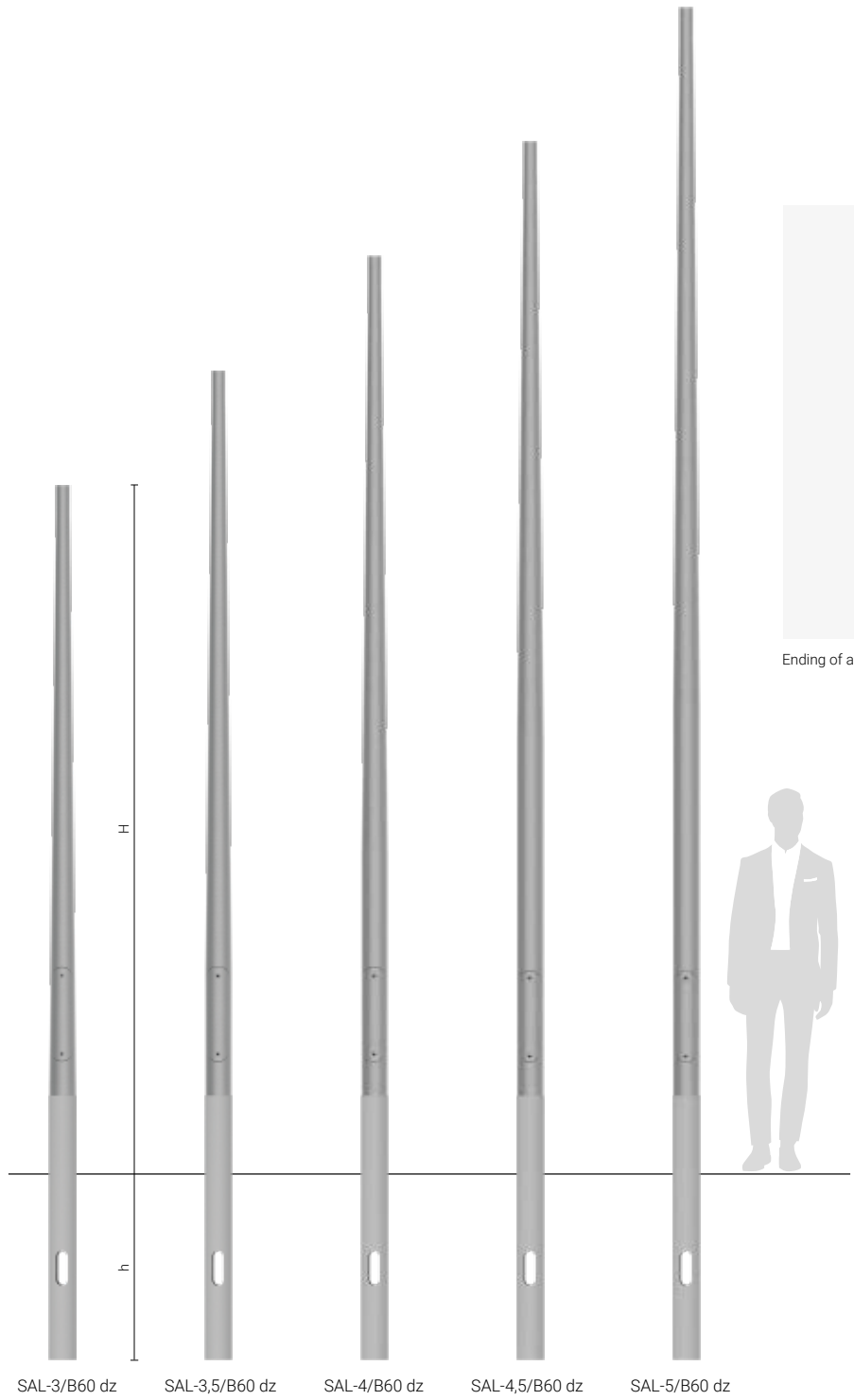

Ending of aluminium column

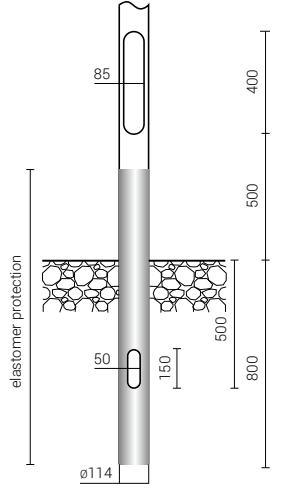

Straight aluminium columns

ø120 mm at the base

Anodising: 10 colours

Finish: brushed anodised aluminium, option of elastomer protection in column's colour up to a height of 350 mm (other height on customer's request)

Diameter of the column ending: ø60

Protection class: IP 54 for the wiring chamber

Luminaire mounting: directly on the column or via an extension arm, luminaires with ø60 mm mounting with weight and surface parameters not exceeding the data from the strength table included in the technical data sheet



Column type	SAL-4	SAL-4,5	SAL-5	SAL-5,5	SAL-6
Height of the column H [mm]	4 000	4 500	5 000	5 500	6 000
Code	42201/C...	42202/C...	42203/C...	42205/C...	42207/C...
Net weight [kg]	14,8	16,4	17,6	19,6	20,6
Approximate unit volume [m ³]*	0,09	0,101	0,112	0,123	0,134
Recommended luminaires for column top mounting	ISKRA LED ALFA, ISKRA LED P ALFA, ELBA LED, RING 1 LED, RING 2 LED, CUDDLE MINI LED REG, ATLANTIS LED, COSMO DELTA LED, MIRA LED, MIZAR LED, ELBA, OPA-1, OP, OZ				
Recommended extension arms and luminaires	WA-41 fi42 - luminaire OW LED; WA-5/1 - luminaire ELBA LED, ATLANTIS LED, OPA-1, OP, OZ; WA-14/1 - luminaire OW LED, DROP LED;				
	WA-14/2- luminaires OW LED, DROP LED;				
Concrete footing / reinforcement basket type	B-50 / Z-50				
Threaded anchor ending	4xM14				
Concrete footing / reinforcement basket code	311150 / 311205				
Fasteners	4006				
Dimension of the base plate (side / bolt spacing / thickness) [mm]	224 / 180 / 8				

* For orders of more than 10 pcs. the given volumes may change due to the method of packaging.
/C... - choice of anodising colour

Radom, Poland



Luminaire: RING 1 LED
Column: SAL-5



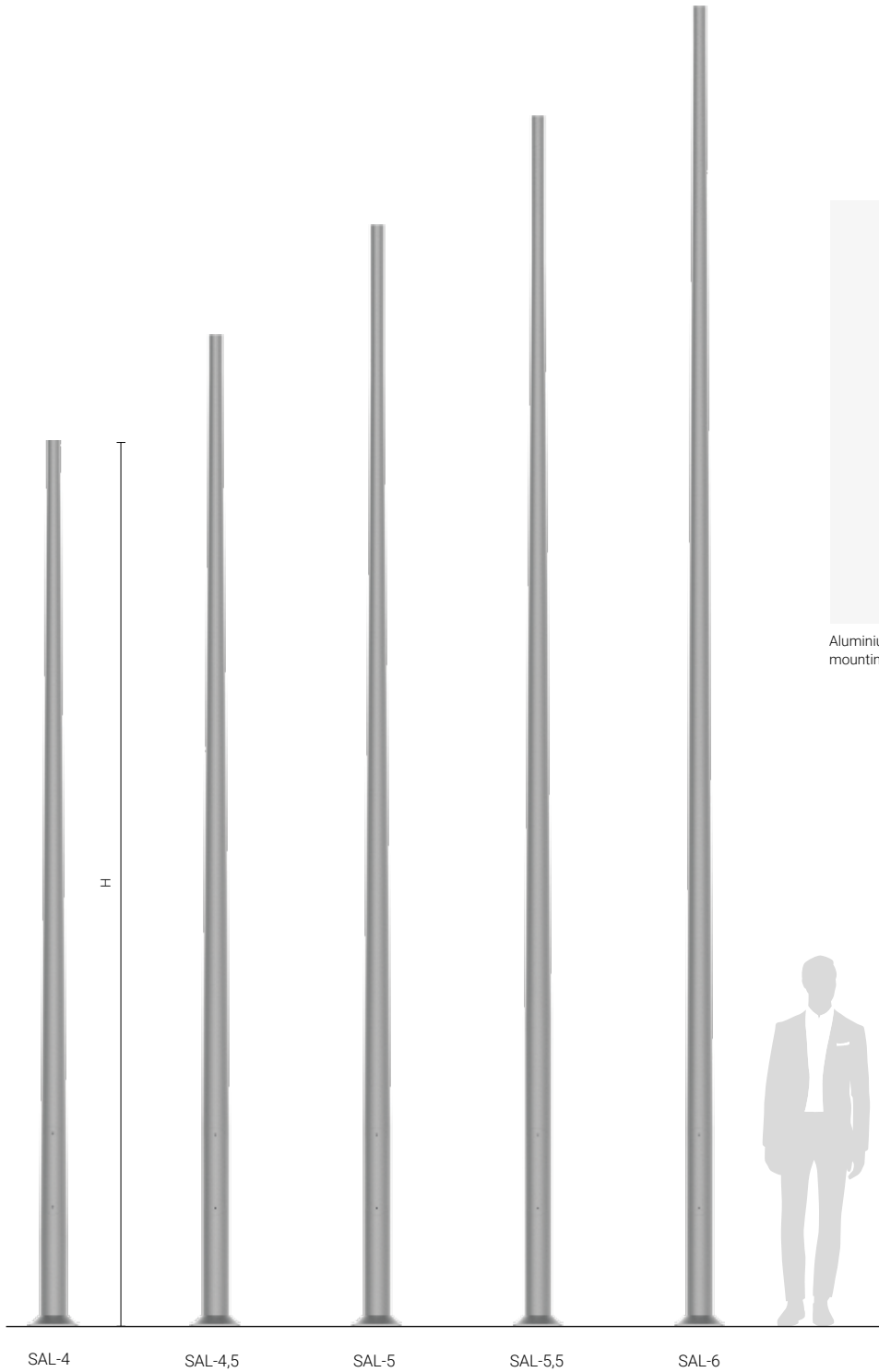

Aluminium column wiring chamber with a mounting rail for a connection box

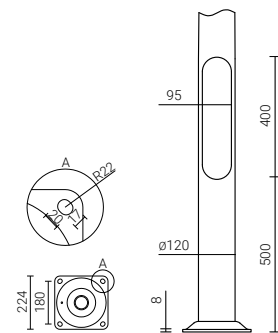

Straight aluminium columns

ø120 mm at the base

Anodising: 10 colours

Finish: brushed anodised aluminium, option of elastomer protection in column's colour up to a height of 350 mm (other height on customer's request)

Diameter of the column ending: ø60 mm

Protection class: IP 54 for the wiring chamber

Luminaire mounting: directly on the column or via an extension arm, luminaires with ø60 mm mounting with weight and surface parameters not exceeding the data from the strength table included in the technical data sheet



Column type	SAL-4E	SAL-4,5E	SAL-5E	SAL-6E
Height of the column H [mm]	4 000	4 500	5 000	6 000
Code	42217/C...	42218/C...	42219/C...	42223/C...
Net weight [kg]	15,2	16,8	18	21
Approximate unit volume [m ³]*	0,116	0,13	0,145	0,174
Recommended luminaires for column top mounting	ISKRA LED ALFA, ISKRA LED ALFA PROG, ISKRA LED P ALFA, ISKRA LED P ALFA PROG, RING 1 LED, RING 2 LED, CUDDLE MINI LED REG, ELBA LED, AURIS LED, ATLANTIS LED, COSMO DELTA LED, MIRA LED, MIZAR LED, ELBA, OPA-1, OP, OZ			
Recommended extension arms and luminaires	WA-41 f142 - luminaire OW LED; WA-5/1 - luminaire ELBA LED, ATLANTIS LED, OPA-1, OP, OZ; WA-14/1 - luminaire OW LED, DROP LED; WA-14/2- luminaires OW LED, DROP LED;			
Concrete footing / reinforcement basket type	B-51 / Z-51			
Threaded anchor ending	4xM18			
Concrete footing / reinforcement basket code	311151 / 311251			
Fasteners	4008			
Dimension of the base plate (side / bolt spacing / thickness) [mm]	260 / 200 / 8			

* For orders of more than 10 pcs. the given volumes may change due to the method of packaging.
/C... - choice of anodising colour

Gorzów Wielkopolski, Poland



Luminaire: CUDDLE MINI LED REG
Column: SAL-5E

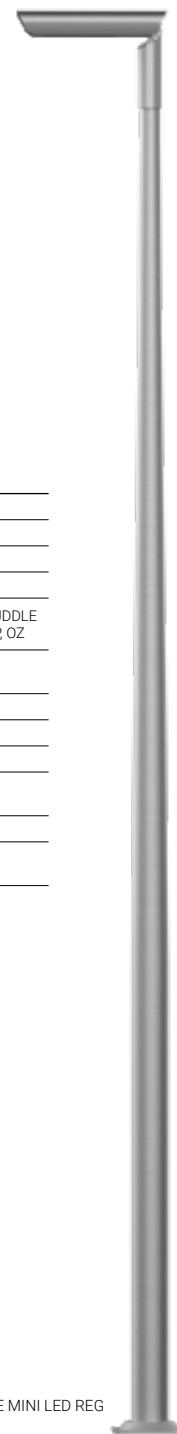

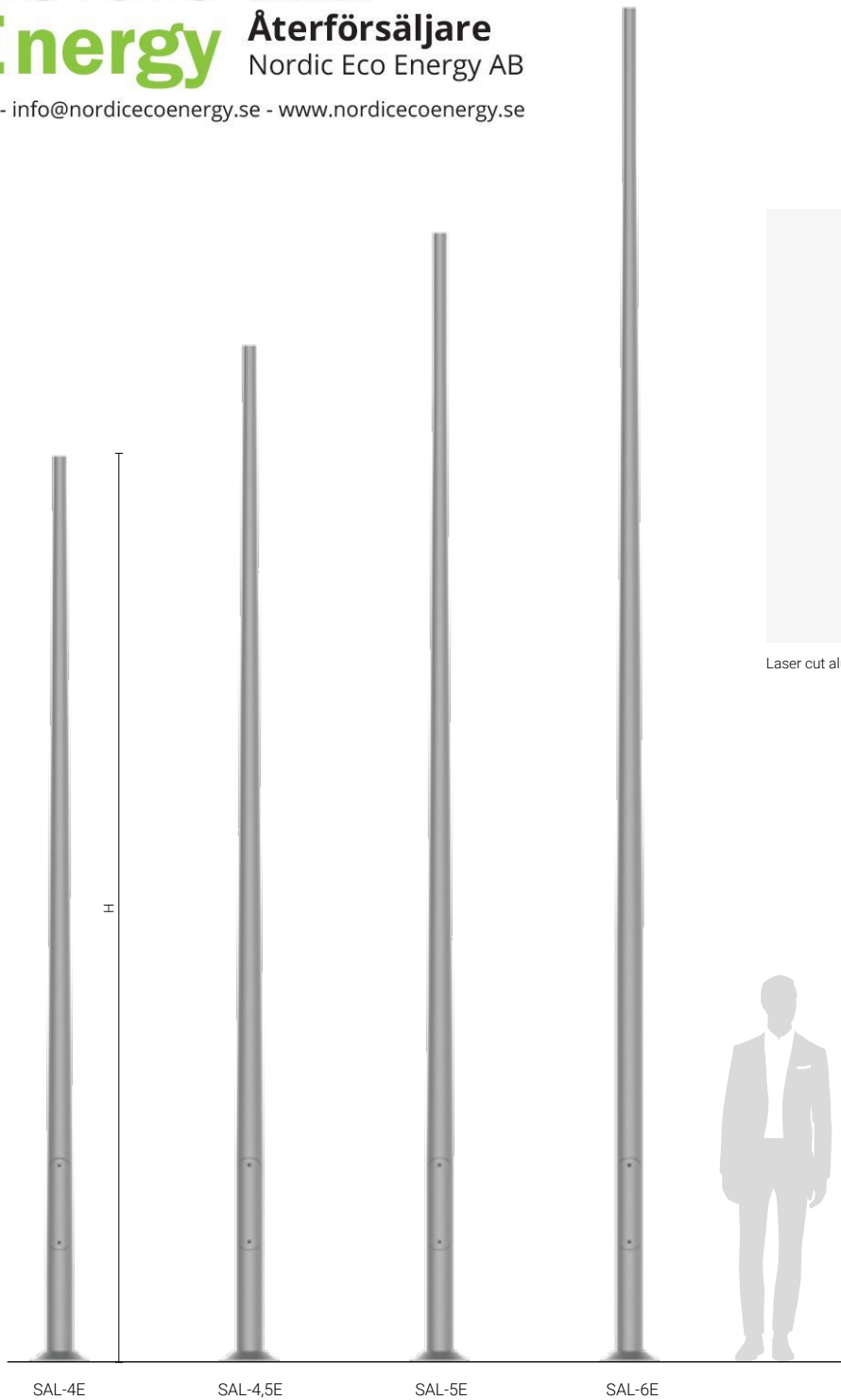

Laser cut aluminium column's wiring chamber

